

## Toad

STD-000552-0053

### Configured Product

Light Source

SL90

Light Source Size

9mm LES

CCT

2700K

Beam

Medium 34.7°

Finish

RAL 9010 Pure White

Attachments

None

Secondary Lensing Accessories

Without accessories

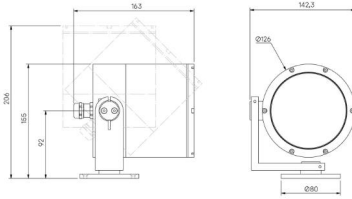

High-performance exterior spotlight system, for ceiling and wall mounting to illuminate exterior architectural details and landscape illumination.

### Product Description

The Toad is a high power IP66 exterior rated, adjustable and lockable spotlight.

Constructed from precision-machined recycled aluminium, the spotlight features an anodised and powder-coated finish for enhanced durability and aesthetics.

Provided with interchangeable optics from Very Narrow to Wide Flood, additional lenses can be added for glare control or to create elliptical beam spreads

### Key Features

- Sustainable construction: Made from recycled aluminium with a weather resistant long-lasting anodised and powder-coated finish. Specialist finishes available on request.
- Fixed optics can be easily swapped from Very Narrow to Flood options, capable of holding up to two additional lens accessories.
- Snoot and Cowl options available.
- Advanced dimming options: DALI, 0-10V, DMX and Wireless dimming, down to 0.1%.
- High-performance lighting: Up to 98 CRI LEDs with interchangeable optical systems.



**STOANE LIGHTING**

Toad

EQUIPMENT DESIGN + MANUFACTURE

STD-000552-0053

Compliance



# Technical

<b>Supply</b>	Remote constant current LED driver required	
<b>Light source</b>	9mm LES COB	14mm LES COB
<b>Initial output</b>	<p><b>SL90</b> 25.4W 36.3Vf at 700mA</p> <p>2700K · 3388lm · 133lm/W            3000K · 3548lm · 140lm/W            3500K · 3587lm · 141lm/W            4000K · 3569lm · 140lm/W</p> <p><b>SL98</b> 30.4W 33.8Vf at 900mA</p> <p>2700K · 2740lm · 90lm/W            3000K · 2928lm · 96lm/W            3500K · 3008lm · 99lm/W            4000K · 3074lm · 101lm/W</p>	<p><b>SL90</b> 30.7W 36.1Vf at 850mA</p> <p>2700K · 4232lm · 100lm/W            3000K · 4431lm · 107lm/W            3500K · 4482lm · 107lm/W            4000K · 4455lm · 113lm/W</p> <p><b>SL98</b> 30.8W 34.2Vf at 900mA</p> <p>2700K · 3370lm · 109lm/W            3000K · 3600lm · 117lm/W            3500K · 3699lm · 120lm/W            4000K · 3667lm · 115lm/W</p>
<b>Light distribution</b>	<p>Very Narrow 11.6°            Medium 34.7°            Flood 42.8°            Wide Flood 45.3°</p>	<p>Narrow 13.8°            Medium 38.9°            Flood 45.1°            Wide Flood 52.6°</p>
<b>Lumen maintenance</b>	L90 B0 in excess of 94,000 hours	
<b>Colour consistency</b>	2 SDCM	
<b>IP rating</b>	IP66	
<b>Weight</b>	2.37kg	

## Service Commitment

