

## Frog

STD-000543-0161

### Configured Product

Light Source

SL90

Light Source Size

9mm LES

CCT

Custom

Beam

TBC

Finish

Matt Black

Attachments

Straight/Slash Cut Snoot (specified separately)

Secondary Lensing Accessories

Without accessories

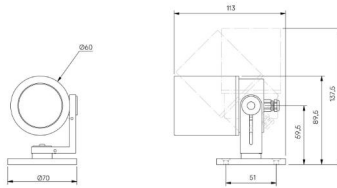

High-performance exterior spotlight system, for surface mounting to illuminate exterior architectural details and landscape illumination.

## Product Description

The Frog is an IP66 exterior rated, adjustable and lockable spotlight. Constructed from precision-machined recycled aluminium, the spotlight features an anodised and powder-coated finish for enhanced durability and aesthetics. Provided with interchangeable optics from Very Narrow to Wide Flood to elliptical beams.

## Key Features

- Sustainable construction: made from recycled aluminium with a weather resistant long-lasting anodised and powder-coated finish. Specialist finishes available on request.
- Fixed optics can be easily swapped from Very Narrow to Flood to elliptical beam options
- Snoot and Cowl options available.
- Tree and Spike mounted options available.
- Advanced dimming options: DALI, 0-10V, DMX and Wireless dimming, down to 0.1%.
- High-performance lighting: up to 98 CRI LEDs with interchangeable optical systems.



**STOANE LIGHTING**

EQUIPMENT DESIGN + MANUFACTURE

Frog

STD-000543-0161

Compliance



# Technical

|                           |   |   |
|---------------------------|---|---|
| <b>Supply</b>             | Remote constant current LED driver required   |   |
| <b>Light source</b>       | 6mm LES COB   | 9mm LES COB   |
| <b>Initial output</b>     | <p><b>SL90</b> 8W 32Vf at 250mA</p> <p>2700K · 1087lm · 136lm/W<br/>           3000K · 1133lm · 141lm/W<br/>           3500K · 1144lm · 143lm/W<br/>           4000K · 1175lm · 147lm/W</p> <p><b>SL98</b> 8.6W 34.4Vf at 250mA</p> <p>2700K · 863lm · 100lm/W<br/>           3000K · 923lm · 107lm/W<br/>           3500K · 923lm · 107lm/W<br/>           4000K · 974lm · 113lm/W</p> | <p><b>SL90</b> 11.8W 33.8Vf at 350mA</p> <p>2700K · 1822lm · 154lm/W<br/>           3000K · 1908lm · 161lm/W<br/>           3500K · 1929lm · 163lm/W<br/>           4000K · 1919lm · 162lm/W</p> <p><b>SL98</b> 10.6W 30.4Vf at 350mA</p> <p>2700K · 1205lm · 113lm/W<br/>           3000K · 1288lm · 121lm/W<br/>           3500K · 1313lm · 124lm/W<br/>           4000K · 1352lm · 127lm/W</p> |
| <b>Light distribution</b> | <p>Very Narrow 13.3°<br/>           Narrow 14.3°<br/>           Medium 24.1°<br/>           Flood 36.8°<br/>           Wide Flood 50.1°</p>   | <p>Narrow 19.2°<br/>           Narrow 2 19.8°<br/>           Medium 26°<br/>           Flood 34.6°<br/>           Wide Flood 53.1°</p>  |
| <b>Lumen maintenance</b>  | L90 B0 in excess of 94,000 hours  |   |
| <b>Colour consistency</b> | 2 SDCM  |   |
| <b>IP rating</b>          | IP66  |   |
| <b>Weight</b>             | 0.62kg  |   |

## Service Commitment

