

# STOANE LIGHTING

EQUIPMENT DESIGN + MANUFACTURE

## Frog

STD-000543-0150

### Configured Product

Light Source

SL90

Light Source Size

9mm LES

CCT

2700K

Beam

Flood 34.6°

Finish

TBC

Attachments

None

Secondary Lensing Accessories

Without accessories

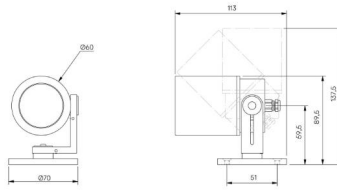

High-performance exterior spotlight system, for surface mounting to illuminate exterior architectural details and landscape illumination.

## Product Description

The Frog is an IP66 exterior rated, adjustable and lockable spotlight. Constructed from precision-machined recycled aluminium, the spotlight features an anodised and powder-coated finish for enhanced durability and aesthetics. Provided with interchangeable optics from Very Narrow to Wide Flood to elliptical beams.

## Key Features

- Sustainable construction: made from recycled aluminium with a weather resistant long-lasting anodised and powder-coated finish. Specialist finishes available on request.
- Fixed optics can be easily swapped from Very Narrow to Flood to elliptical beam options
- Snoot and Cowl options available.
- Tree and Spike mounted options available.
- Advanced dimming options: DALI, 0-10V, DMX and Wireless dimming, down to 0.1%.
- High-performance lighting: up to 98 CRI LEDs with interchangeable optical systems.



**STOANE LIGHTING**

EQUIPMENT DESIGN + MANUFACTURE

Frog

STD-000543-0150

Compliance



# Technical

<b>Supply</b>	Remote constant current LED driver required	
<b>Light source</b>	6mm LES COB	9mm LES COB
<b>Initial output</b>	<p><b>SL90</b> 8W 32Vf at 250mA</p> <p>2700K · 1087lm · 136lm/W                  3000K · 1133lm · 141lm/W                  3500K · 1144lm · 143lm/W                  4000K · 1175lm · 147lm/W</p> <p><b>SL98</b> 8.6W 34.4Vf at 250mA</p> <p>2700K · 863lm · 100lm/W                  3000K · 923lm · 107lm/W                  3500K · 923lm · 107lm/W                  4000K · 974lm · 113lm/W</p>	<p><b>SL90</b> 11.8W 33.8Vf at 350mA</p> <p>2700K · 1822lm · 154lm/W                  3000K · 1908lm · 161lm/W                  3500K · 1929lm · 163lm/W                  4000K · 1919lm · 162lm/W</p> <p><b>SL98</b> 10.6W 30.4Vf at 350mA</p> <p>2700K · 1205lm · 113lm/W                  3000K · 1288lm · 121lm/W                  3500K · 1313lm · 124lm/W                  4000K · 1352lm · 127lm/W</p>
<b>Light distribution</b>	<p>Very Narrow 13.3°                  Narrow 14.3°                  Medium 24.1°                  Flood 36.8°                  Wide Flood 50.1°</p>	<p>Narrow 19.2°                  Narrow 2 19.8°                  Medium 26°                  Flood 34.6°                  Wide Flood 53.1°</p>
<b>Lumen maintenance</b>	L90 B0 in excess of 94,000 hours	
<b>Colour consistency</b>	2 SDCM	
<b>IP rating</b>	IP66	
<b>Weight</b>	0.62kg	

## Service Commitment

