

STOANE LIGHTING

EQUIPMENT DESIGN + MANUFACTURE

ZTA.50.Surface.Framer STD-000506-0191

Modular high-performance, surface mounted spotlight system, for interior architectural applications such as Museums, Galleries and Retail. Engineered for exceptional durability, maintainability, re-manufacturability, and recyclability, this spotlight sets a new standard for sustainable design.

Product Description

ZTA.50.Surface.Framer is constructed from extruded and precision-machined recycled aluminium, the spotlight features an anodised and powder-coated finish for enhanced durability and aesthetics. Easily interchangeable between Framing projector, fixed optic, Wall Wash and Zoom options.

Fixed uses a Wide Flood spread for long throws. Adjustable uses a Zoom lens to allow the user to narrow in on very fine details. Both are capable of holding a gobo.

Key Features

- Sustainable construction: made from recycled aluminium with a long-lasting anodised and powder-coated finish. Specialist finishes available on request.
- Framing attachment can be easily swapped to fixed optics, Zoom and Wall Wash.
- The easy-to-adjust fins allow for precision positioning to sharply define light on pieces of artwork.
- Versatile adjustment: 363° pan rotation and 130° tilt with a lockable spot.
- High-performance lighting: up to 98 CRI LEDs with interchangeable optical systems.

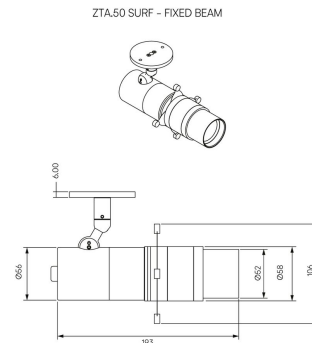
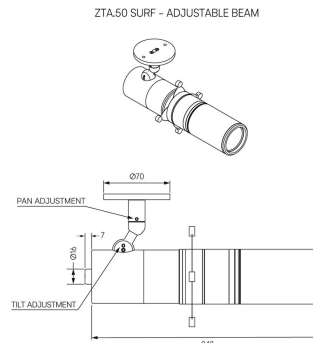

STOANE LIGHTING

EQUIPMENT DESIGN + MANUFACTURE

ZTA.50.Surface.Framer STD-000506-0191

· Advanced dimming options: DALI,
0-10V, DMX and Wireless dimming,
down to 0.1%.

ZTA.50.Surface.Framer
STD-000506-0191

Configured Product

Light source

9.8mm LES

CCT

3000K

CRI

90

Supply

Constant Current

Finish

RAL 9003 Signal White

Dimming

Driver specific

Cable route

Through Base

Cable Length

500mm

Softening Diffuser

Yes

Framer type

Adjustable Beam