

STOANE LIGHTING

EQUIPMENT DESIGN + MANUFACTURE

ZTA.50.Surface.Framer STD-000506-0188

Modular high-performance, surface mounted spotlight system, for interior architectural applications such as Museums, Galleries and Retail. Engineered for exceptional durability, maintainability, re-manufacturability, and recyclability, this spotlight sets a new standard for sustainable design.

Product Description

ZTA.50.Surface.Framer is constructed from extruded and precision-machined recycled aluminium, the spotlight features an anodised and powder-coated finish for enhanced durability and aesthetics. Easily interchangeable between Framing projector, fixed optic, Wall Wash and Zoom options.

Fixed uses a Wide Flood spread for long throws. Adjustable uses a Zoom lens to allow the user to narrow in on very fine details. Both are capable of holding a gobo.

Key Features

- Sustainable construction: made from recycled aluminium with a long-lasting anodised and powder-coated finish.
- Framing attachment can be easily swapped to fixed optics, Zoom and Wall Wash.
- The easy-to-adjust fins allow for precision positioning to sharply define light on pieces of artwork.
- Versatile adjustment: 363° pan rotation and 130° tilt with a lockable spot.
- High-performance lighting: up to 98 CRI LEDs with interchangeable optical systems.
- Advanced dimming options: DALI,

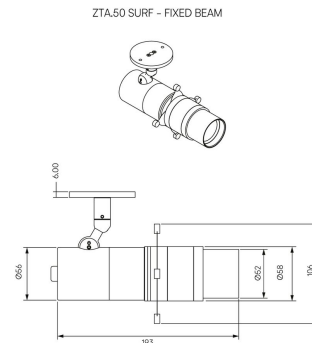
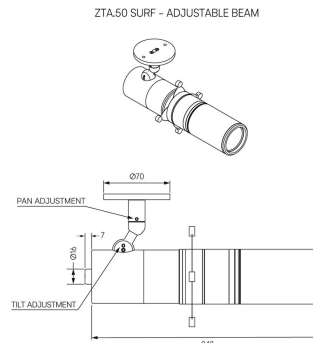

STOANE LIGHTING

EQUIPMENT DESIGN + MANUFACTURE

ZTA.50.Surface.Framer STD-000506-0188

0-10V, DMX and Wireless dimming,
down to 0.1%.

ZTA.50.Surface.Framer
STD-000506-0188

Configured Product

Light source

9mm LES

CCT

3000K

CRI

95

Supply

Constant Current

Finish

Matt Black

Dimming

Driver specific

Cable route

Through Base

Cable Length

500mm

Softening Diffuser/Accessory

Yes

Framer type

Adjustable Beam