

## Mini G-Cat

STD-000410-0080

### Configured Product

CCT \_\_\_\_\_

2700K

Beam \_\_\_\_\_

Wide Flood 51.3°

Supply \_\_\_\_\_

One Circuit

Finish \_\_\_\_\_

Anodised Clear



Compact exterior lighting system, to enhance outdoor public spaces, pathways and more intimate hospitality and high end residential applications.

## Product Description

The Mini G-Cat is an award winning IP66 exterior rated compact lighting system that offers versatile lighting options.

Clear polished, internally frosted Decorative Globe is joined by:

**Low Glare** A custom acrylic designed to minimise upward light spill. Suitable for Dark Sky applications.

**Technical Optics** Very Narrow - Wide Flood options supplied with low glare snoot and frosted glass with provision for one lens accessory.

## Key Features

- Sustainable construction: made from recycled aluminium with a weather resistant long-lasting anodised and powder-coated finish. Specialist finishes available on request.
- IK10 rated.
- Adjustable beam angles with interchangeable optics with no upward light spill.
- Specialist Globe diffuser for decorative glow.
- Advanced dimming options: DALI, 0-10V, DMX and Wireless dimming, down to 0.1%.
- High-performance lighting: Up to 90 CRI LEDs

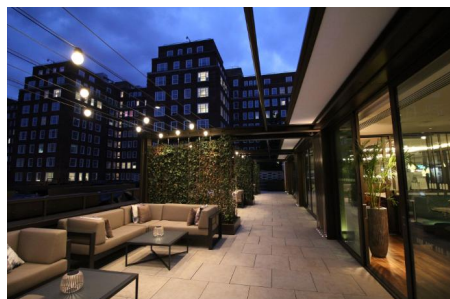

## Compliance



## Technical

Supply	Remote constant current LED driver required
Light source	6mm LES COB
Initial output	90 CRI 6.3W 9Vf at 700mA  2400K · 706lm · 119lm/W 2700K · 763lm · 129lm/W 3000K · 792lm · 134lm/W 3500K · 809lm · 137lm/W 4000K · 826lm · 140lm/W
Light distribution	Decorative Globe 84.4° Low Glare 63.7° Very Narrow 12.6° Medium 25.5° Flood 36.6° Wide Flood 51.3°
Colour consistency	3 SDCM
IP rating	IP66
IK rating	IK10
Weight	0.87kg

## Service Commitment

