

## LED Goal

STD-000057-0030

### Configured Product

LED \_\_\_\_\_

SL G3.2 Strip Standard Output

CCT \_\_\_\_\_

3000K

Length \_\_\_\_\_

Custom Length

Finish \_\_\_\_\_

Anodised Brass/Bronze

Stem Height \_\_\_\_\_

210mm

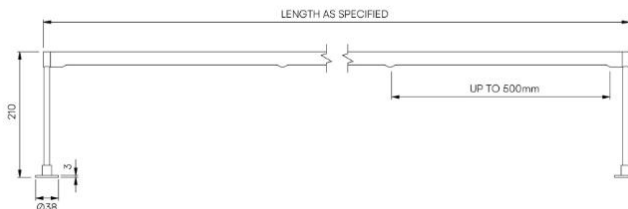

Linear lighting system, for Museum, Gallery and Retail display lighting.

## Product Description

The LED Goal is a linear profile designed to provide illumination for Museum, Gallery and Retail applications when wall mounted or library/ reading room applications when vertically mounted. A soft diffuse light is provided via a customised frosted diffuser. The product includes tilt rotation and a discreet locking system.

The product length and height can be specified and longer lengths can be manufactured using additional modules and supporting legs.

There are typically 2 x apertures per metre.

## Key Features

- Sustainable construction: made from recycled aluminium.
- Both the length and height can be specified.
- High and Low output options available with a custom frosted diffuser for a soft lit effect.
- Advanced dimming options: DALI, 0-10V, DMX and Wireless dimming, down to 0.1%.
- High-performance lighting: Up to 90 CRI LEDs.

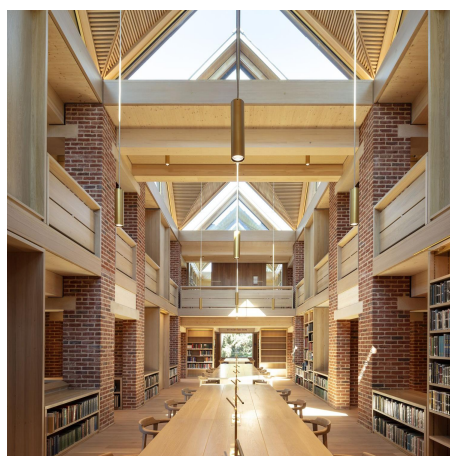
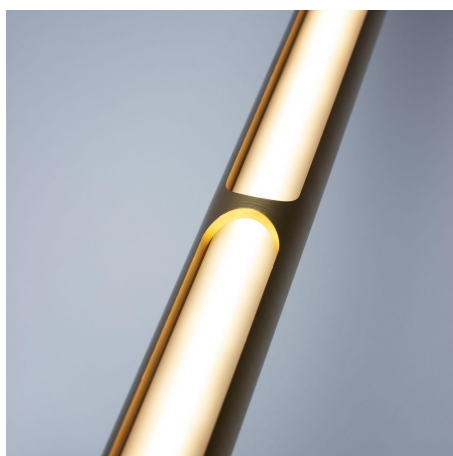

## Compliance



---

## Service Commitment



---

## Technical

Light Source

Standard Output LED Strip

90 CRI

High Output LED Strip

90 CRI

1496lm/m initial output at 3000K  
89lm/W

2702lm/m initial output at  
3000K 86.6lm/W

Light

Asymmetric

Distribution

105.8°x107°