

## Module Star STD-000019-0005

Compact recessed fixed focus module, for enhancing both interior and exterior architectural details. Capable of recessing into walls, ceilings and furniture.

### Product Description

The Module Star is an IP66 rated fixed module, suitable for recessing into walls, ceiling or furniture, it can also be integrated into various architectural and lighting details via an M3 Stud or magnet.

### Key Features

- Sustainable construction: made from recycled aluminium with a long-lasting anodised finish. Specialist finishes available on request. Includes toughened glass lens.
- Interchangeable optics to allow Narrow to Wide Flood to elliptical beam options.
- Advanced dimming options: DALI, 0-10V, and Wireless dimming, down to 0.1%.
- High-performance lighting: up to 97 CRI LEDs.

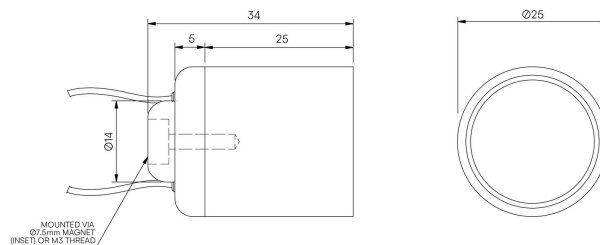

# STOANE LIGHTING

EQUIPMENT DESIGN + MANUFACTURE

## Module Star STD-000019-0005

Configured Product

CCT

3000K

Beam

TBC

Finish

Please contact us for custom finishing requirements

Anodised Clear

Mounting Method

Screw